



AIC-6200 Series MPEG-4 Network Streaming IP Speed Dome



Main Features:

- 1/4" Sony SuperHAD CCD sensor
- 352X zoom: 22X optical zoom and 16X digital zoom (AIC-6200/6210)
- 270X zoom: 27X optical zoom and 10X digital zoom (AIC-6220/6230)
- Day & Night (AIC-6220/6230), built-in ICR (IR Cut Filter Removable)
- Built-in heater/fan for outdoor type (AIC-62xxE/W/C/P)
- MPEG-4 ASP compliant hardware compression
- CIF up to Full D1 resolution at 30/25 FPS
- Dual MPEG-4 video stream output via LAN and WAN (PPPoE supported) ports at the same time
- QoS enabled (L3) for video streaming
- PPPoE supported
- DDNS supported
- Remote Pan/Tilt/Zoom control

Outdoor wall mount

► Appearance

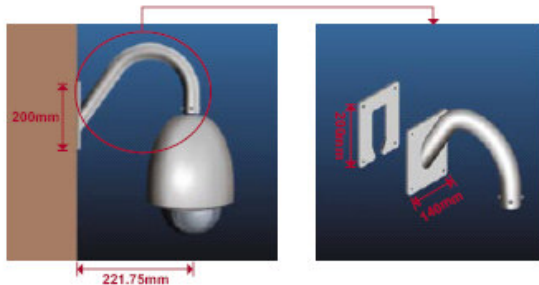

Outdoor pole mount

► Appearance

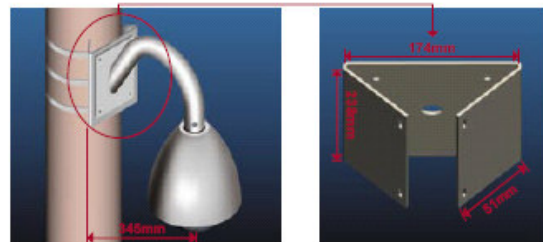

Outdoor corner mount

► Appearance

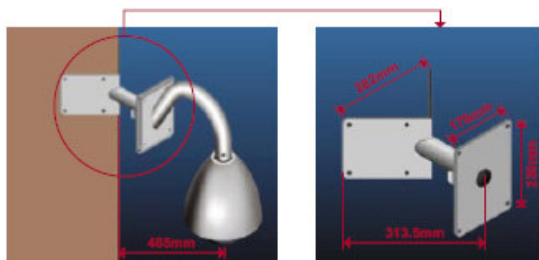

Outdoor ceiling mount

► Appearance

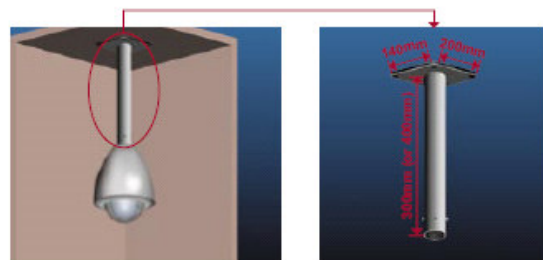

Indoor ceiling mount



Product Specification

		CAM-6200	CAM-6210	6220	6230	
Image	Size	SONY SuperHAD 1/4 inch CCD				
	Effective Pixels (HxV)	811 X 508 (NTSC); 795 X 596 (PAL)				
	Horizontal Resolution	More than 470 TVL				
Minimum Illumination		Color 1.0 Lux, B/W: N/A		Color 1.0 Lux, B/W: 0.1 Lux		
Lens	Focal Length	3.9 ~ 85.8 mm		3.25 ~ 88 mm		
	Zoom Ratio	22x		27x		
	Aperture Ratio	F1.6 (Wide), F3.7 (Tele)		F1.5 (Wide), F3.6 (Tele)		
	Diagonal Angle	72.19° (W) ~ 3.48° (T)		82.3° (W) ~ 3.43° (T)		
	Digital Zoom	22X optical zoom; 16X digital zoom		27X optical zoom; 10X digital Zoom		
Sync. System		Internal				
Day/Night Switching		N/A		IR cut filter		
Functions	Motion Detection	Yes (3 windows)				
	Electronic Shutter	1/60 ~ 1/100,000 sec. (NTSC); 1/50 ~ 1/100,000 sec. (PAL)				
	Fixed Shutter	Manual 27 steps ,1/125~1/10,000 sec. (NTSC); Manual 27 steps ,1/125~1/10,000 sec. (PAL)				
	BLC	On / Off				
	AGC	Auto / manual				
	Auto Exposure Control	Auto / manual / backlight compensation				
	White Balance	AWB / ATW / PWB/ Manual				
	Number of Preset	32 points				
	Auto Iris Control	Auto / manual				
S/N Ratio	S/N Ratio	Better than 48 dB				
PAN/TILT	Manual Speed	0.5° ~ 55° / sec.				
	Preset Speed	55° / sec.				
	Preset Accuracy	Approximating 1.5° per rotation				
	Travel Range	Pan	360° endless			
		Tilt	0° ~ 90°			
Video (Compression)	Compression	MPEG-4 ASP Compliant				
	Picture Resolution	Full D1 (720 x 480 in NTSC, 720 x 576 in PAL); CIF (352 x 240 in NTSC, 352 x 288 in PAL); QCIF (160 x 112 in NTSC, 176 x 144 in PAL)				
	Bit Rate	28 K ~ 3M bps				
Image Frame Rate		30 fps at full D1 resolution (NTSC); 25 fps at full D1 resolution (PAL)				
Video Output	Composite Output	CVBS, 1.0Vp-p with 75 Ω loading, BNC connector				
Network	LAN Port	Ethernet (10/100Base-T), RJ-45 connector				
	WAN Port	Ethernet (10/100Base-T), RJ-45 connector				
	Protocol	TCP, UDP, IP, HTTP, DHCP, PPPoE				
Software	Web Browser	Microsoft Internet Explorer 6.0 or above				
Operating	Temperature	5 ~ 40°C (41~104°F)				
Power	Power Requirement	Outdoor: AC 24 V; Indoor: DC 12 V				
	Power Consumption	Outdoor: 52 W; Indoor: 20 W				
Others	Vandal Proof	N/A	Yes	N/A	Yes	
Physical	Dimensions (ØxH)	Outdoor: 246mm x 376.5 mm; Indoor: 249.8mm x 283mm				
	Weight	Outdoor: 8Kg (17.62lb); Indoor: 2.5Kg (5.51lb)				

Ordering Information

Part Number	NTSC	PAL	22x Optical Zoom	27x Optical Zoom	Vandal Proof	Indoor	Outdoor			
							Wall Mount	Corner Mount	Ceiling Mount	Pole Mount
AIC-6200NN	V		V			V				
AIC-6200NW	V		V				V			
AIC-6200NC	V		V					V		
AIC-6200NE	V		V						V	
AIC-6200NP	V		V							V
AIC-6210NW	V		V		V		V			
AIC-6210NC	V		V		V			V		
AIC-6210NE	V		V		V				V	
AIC-6210NP	V		V		V					V
AIC-6220NW	V			V			V			
AIC-6220NC	V			V				V		
AIC-6220NE	V			V					V	
AIC-6220NP	V			V						V
AIC-6230NW	V			V	V		V			
AIC-6230NC	V			V	V			V		
AIC-6230NE	V			V	V				V	
AIC-6230NP	V			V	V					V
AIC-6200PN		V	V			V				
AIC-6200PW		V	V				V			
AIC-6200PC		V	V					V		
AIC-6200PE		V	V						V	
AIC-6200PP		V	V							V
AIC-6210PW		V	V		V		V			
AIC-6210PC		V	V		V			V		
AIC-6210PE		V	V		V				V	
AIC-6210PP		V	V		V					V
AIC-6220PW		V		V			V			
AIC-6220PC		V		V				V		
AIC-6220PE		V		V					V	
AIC-6220PP		V		V						V
AIC-6230PW		V		V	V		V			
AIC-6230PC		V		V	V			V		
AIC-6230PE		V		V	V				V	
AIC-6230PP		V		V	V					V